



Finish Your Quilt with a Gallery Facing



Finish Your Quilt with a Gallery Facing

- Facing a quilt will give it a contemporary, clean look.
- A gallery finish on my art quilts prepares them to hang in any environment.
- The following presentation will show you all the steps to add a gallery facing with mitered corners.



Finish Your Quilt with a Gallery Facing

- This mini-quilt has been pieced, but not finished, for several years. It's time to get it done!
- It's an example of the "treasure hunting" I like to do deep inside images of lovely gems. Here's this quilt's inspiration....



Finish Your Quilt with a Gallery Facing

- Trim the raw edges to the desired finished size.

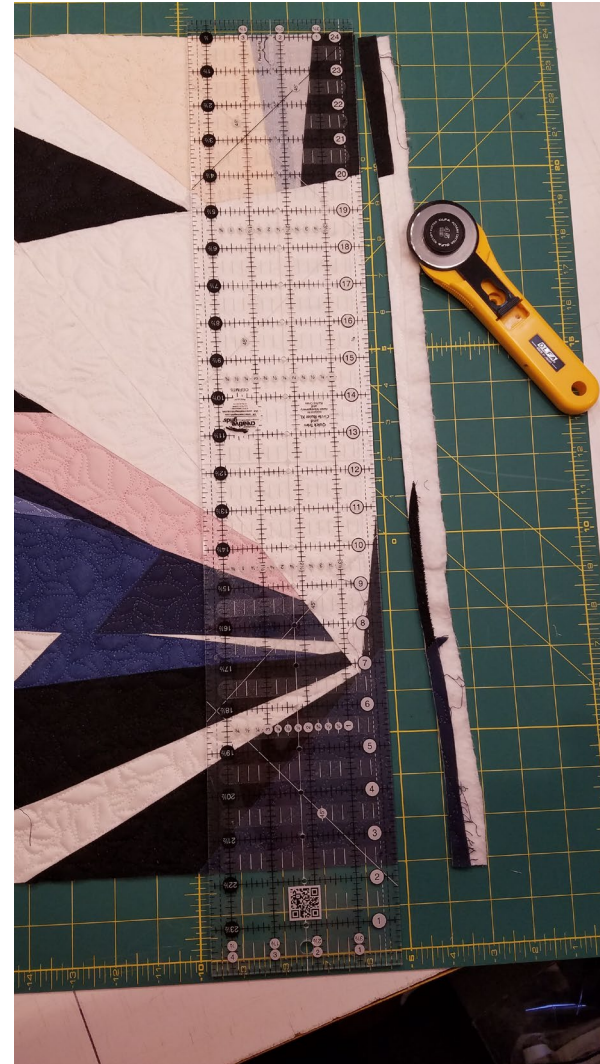

Finish Your Quilt with a Gallery Facing

- Trim the raw edges to the desired finished size.
- Cut (4) 2" strips the length of the sides PLUS 4". This will give you an overhang of 2" on either side of the quilt edge.



Finish Your Quilt with a Gallery Facing

- Trim the raw edges to the desired finished size.
- Cut (4) 2" strips the length of the sides PLUS 4". This will give you an overhang of 2" on either side of the quilt edge.
- Turn up and iron a long edge of each quilt by $\frac{1}{4}$ "



Finish Your Quilt with a Gallery Facing

- Lay the unfolded edge of the strip along the edge of the FRONT of your quilt.
- Mark each end of the strip in 2 places:
 - At the edge of your quilt
 - $\frac{1}{4}$ " from the edge



Finish Your Quilt with a Gallery Facing

- Pin the strip to the quilt placing a pin in the mark $\frac{1}{4}$ " inside the edge of the quilt.
- Stitch the strip to the quilt, starting and ending at the $\frac{1}{4}$ " mark.



Finish Your Quilt with a Gallery Facing

- Pull back the end of the strip you just sewed to your quilt so that it is out of the way of the second strip you're about to sew.



Finish Your Quilt with a Gallery Facing

- Pull back the end of the strip you just sewed to your quilt so that it is out of the way of the second strip you're about to sew.
- Sew a strip to the adjacent side, starting and stopping $\frac{1}{4}$ " from the edges.
- The 2 strips should meet up at the edges but not overlap.



Finish Your Quilt with a Gallery Facing

- Fold each strip over itself to create a 45 degree angle to the corner point of the quilt.
- Press to create a crease. This will serve as the guide over which you'll pin and sew to get your mitered corner.

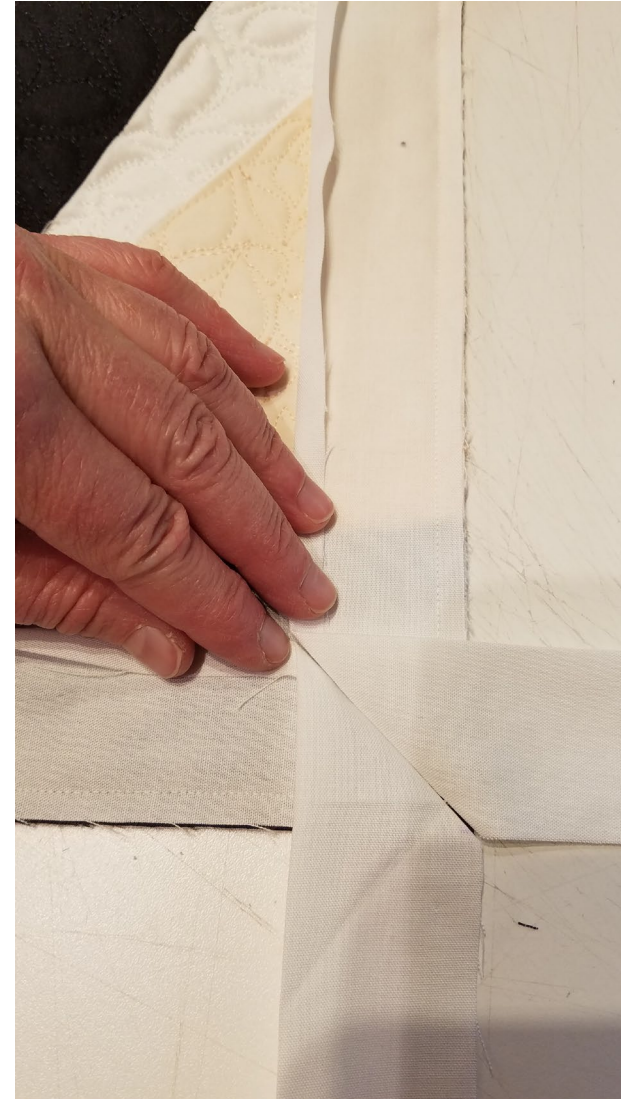

Finish Your Quilt with a Gallery Facing

- Bring the 2 folded edges of the quilt together so that the creased folds align.
- I pull the quilt away from the strips to get it out of the way of the pins.
- Pin along the crease lines.



Finish Your Quilt with a Gallery Facing

- Sew from the folded edge of the strip to the corner.



Finish Your Quilt with a Gallery Facing

- Sew from the folded edge of the strip to the corner.
- Be sure to turn back the quilt edges **AWAY** from the stitch line, because....



Finish Your Quilt with a Gallery Facing

- Sew from the folded edge of the strip to the corner.
- Be sure to turn back the quilt edges AWAY from the stitch line, because....
- You're likely to grab the edge of it on the back side...like I just did. (Love my Ripper!) (Oh, this picture also shows where I clipped the ends of the strips off.)

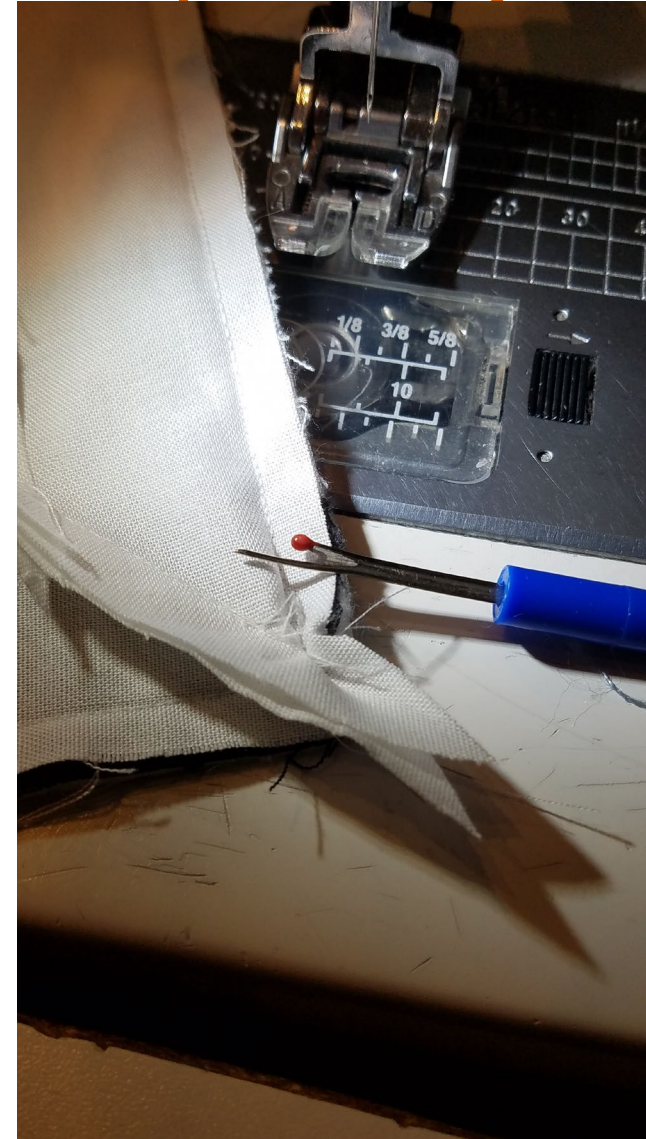

Finish Your Quilt with a Gallery Facing

- Sew from the folded edge of the strip to the corner.
- Be sure to turn back the quilt edges AWAY from the stitch line, because....
- You're likely to grab the edge of it on the back side...like I just did. (Love my Ripper!)
- That's when you try stitching from the other direction. LOL!

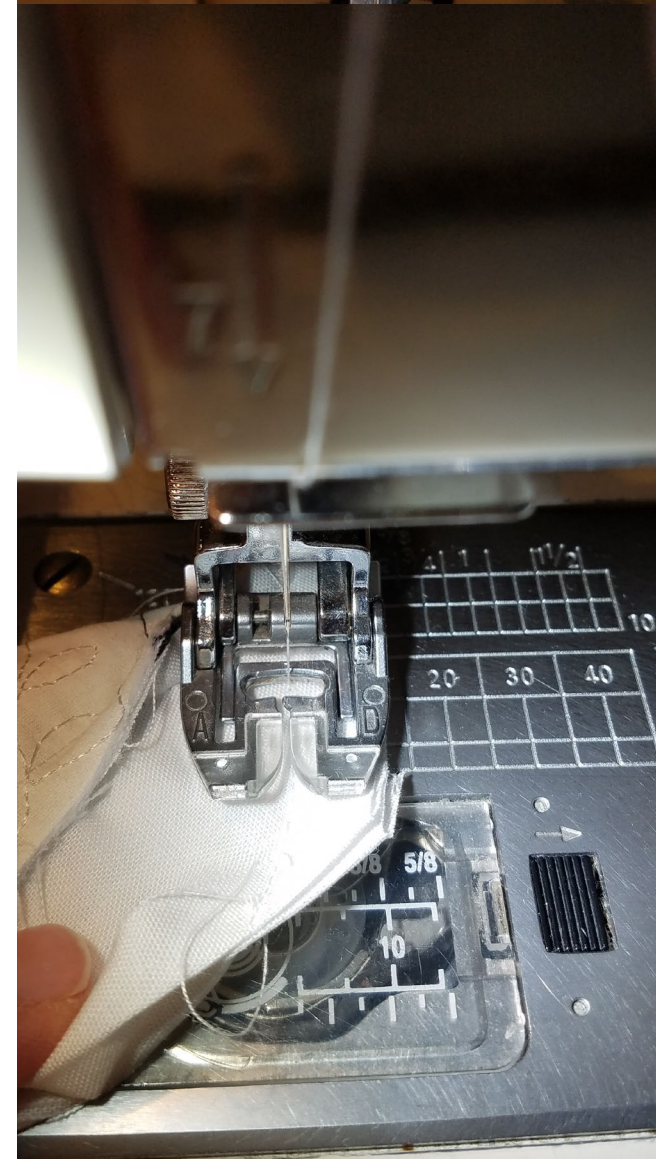

Finish Your Quilt with a Gallery Facing

- Remove the bulky fabric in the corner by clipping 3 places
 - The dog-ears from the strips
 - The corner of the quilt sandwich
 - The edges of the quilt, tapering it down to the corner

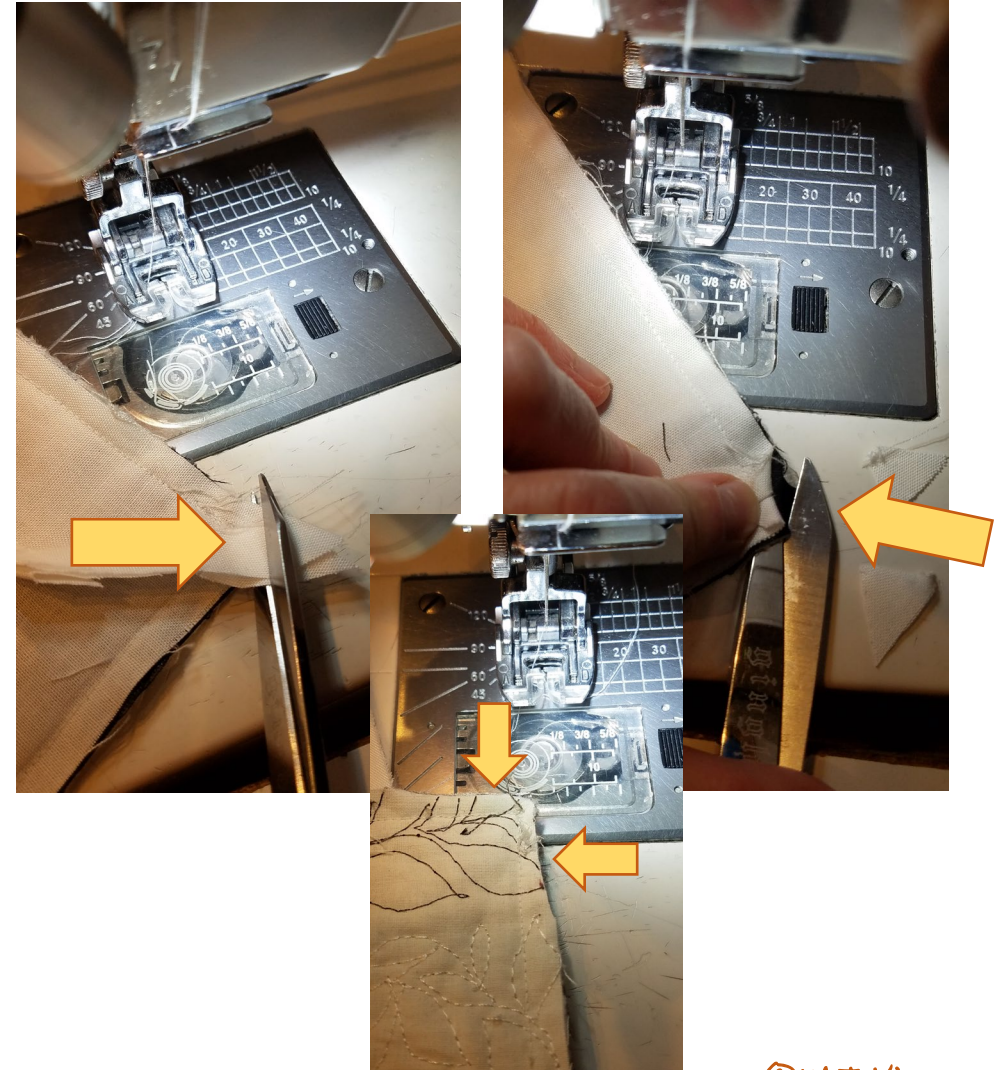

Finish Your Quilt with a Gallery Facing

- Turn the quilt to the front...
- Iron the facing strip away from the quilt top.
- You won't be able to iron it all the way to the corner, due to the envelope formed by the mitered edge.

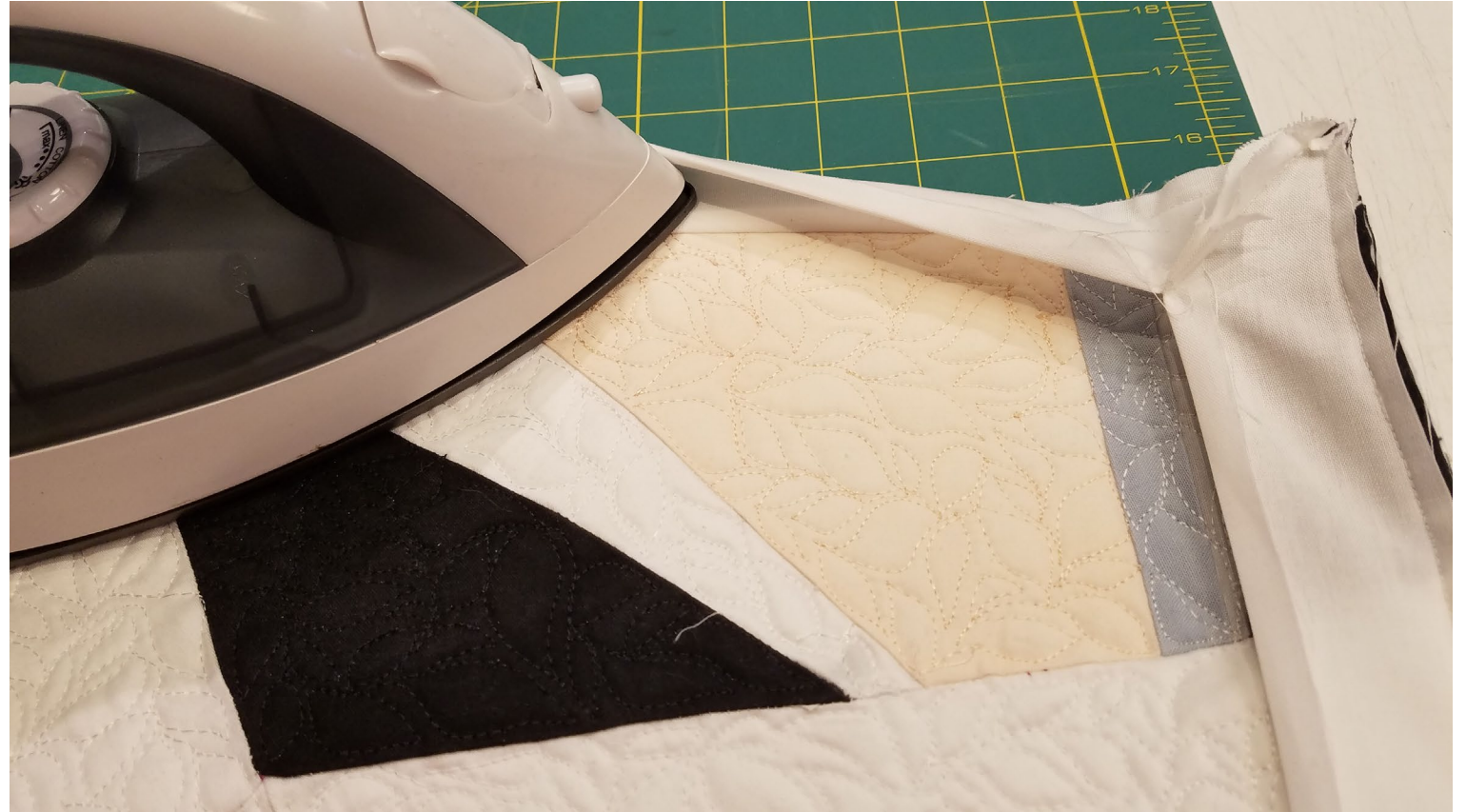

Finish Your Quilt with a Gallery Facing

- On the front side of the quilt, with the facing strip pressed AWAY from the quilt top....
-place a line of stitching just a needle-width or so in the facing strip. This is a tailor's trick to help you turn the facing.



Finish Your Quilt with a Gallery Facing

- Turn the facing to the back of the quilt and gently push the corner to a point.



Finish Your Quilt with a Gallery Facing

- Turn the facing to the back of the quilt and gently push the corner to a point.
- Turn the quilt to the back and work the facing to the back with just a smidge of the quilt top showing at the edge.

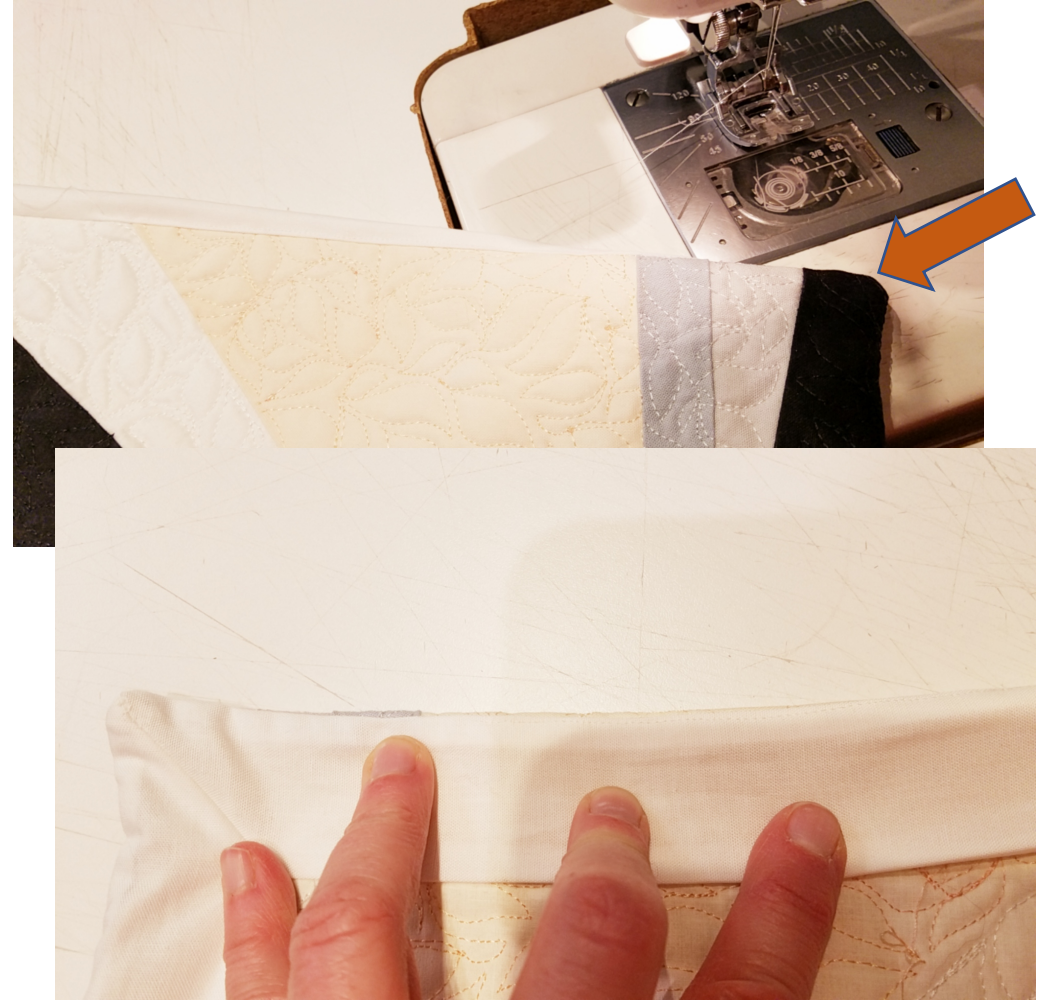

Finish Your Quilt with a Gallery Facing

- Pin the edges in place.
- Here's a peek at what it will look like on the front.
- Hand-stitch the folded edge of the facing to the quilt.

Congratulations!

